

REVISIONS			
NO.	DATE	DESCRIPTION	BY / CNO
1	3/12/12	ADDED HCDS51-SO-HP	JM

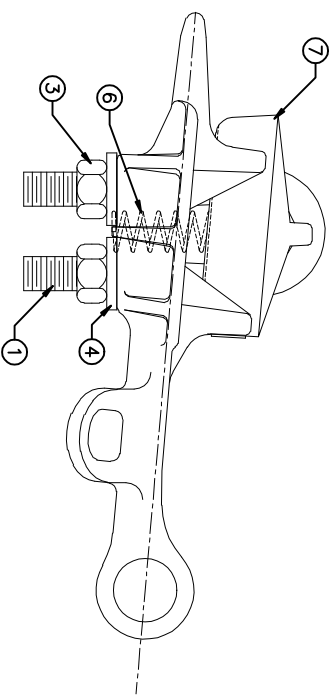
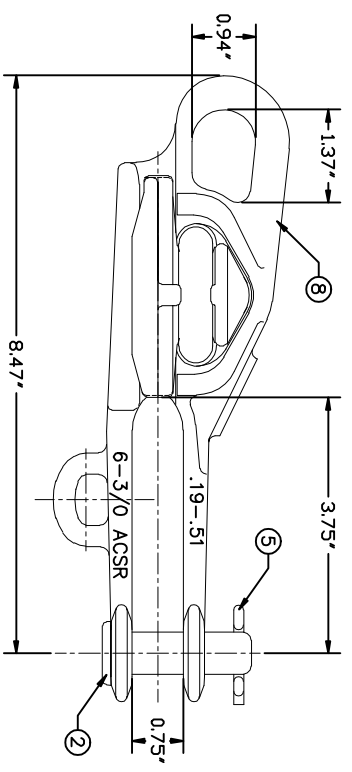

ITEM NO.	PART NO.	CAT. NO.	DESCRIPTION	QUANTITY			
				A	B	C	D
1	P56021	H-0201-24	1/2" U-BOLT	1	1		
2	P56094	H-0315-03	5/8"φ x 2-1/16" CLEVIS PIN	1	-		
3	P56138	H-0400-04-W	1/2"-13 HEX NUT FIN	2	2		
4	P56294	H-0500-04	1/2" FLATWASHER	2	2		
5	P61134	M-111-3	LONG COTTER PIN	1	1		
6	P61190	H-0476-03	0.312" x 2.38" COMP. SPRING	1	1		
7	P63218	*HCDS51-K	HCDS51 KEEPER	1	1		
8	P63244	*HCDS51-SOB	HCDS51 BODY	1	1		
9	P61654	H-0320-03	5/8"φ x 2-1/8" HEX CLEVIS PIN	-	1		

ASSEMBLY NUMBER	REF. NO.
HCDS51-SO	A
HCDS51-SO-HP	B
	C
	D

NOTES:
 1. MATERIAL - BODY AND KEEPER: A356-T6 ALUMINUM ALLOY
 HARDWARE: STEEL, HOT DIP GALVANIZED PER ASTM-A153
 COTTER PIN AND COMP. SPRING: STAINLESS STEEL

2. ULTIMATE STRENGTH - BODY: 8,000 LBS.
 EYE: 6,000 LBS.
 3. CLAMPING RANGE - 0.19" TO 0.51"



DEAD END SIDE OPENING CLAMP
 HCDS51-SO & HCDS51-SO-HP

This information is confidential and is the property of Maclean Power Systems. It may not be made public or reproduced except that the Customer may make copies for use solely in installation, maintenance, and operation of products supplied by Maclean Power Systems.

ENG. REF.

DATE 12/6/2011	SIZE	NO.	REV.	REV.	REV.	REV.	REV.
DATE 12/6/2011	SIZE	NO.	REV.	REV.	REV.	REV.	REV.
DATE 12/6/2011	SIZE	NO.	REV.	REV.	REV.	REV.	REV.
DATE 12/6/2011	SIZE	NO.	REV.	REV.	REV.	REV.	REV.

BC8556-1

1/1