

REVISIONS				
NO.	DATE	DESCRIPTION	BY	CHKD

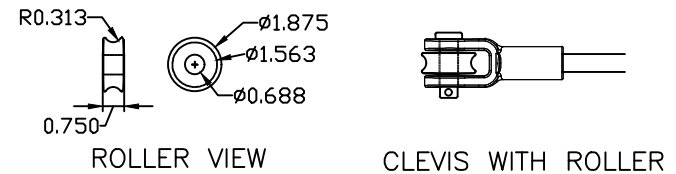
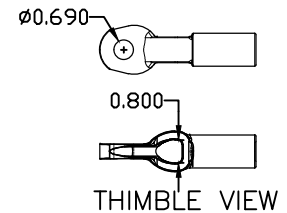
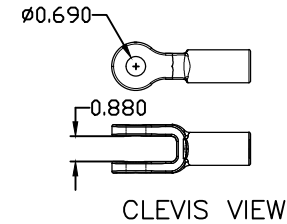
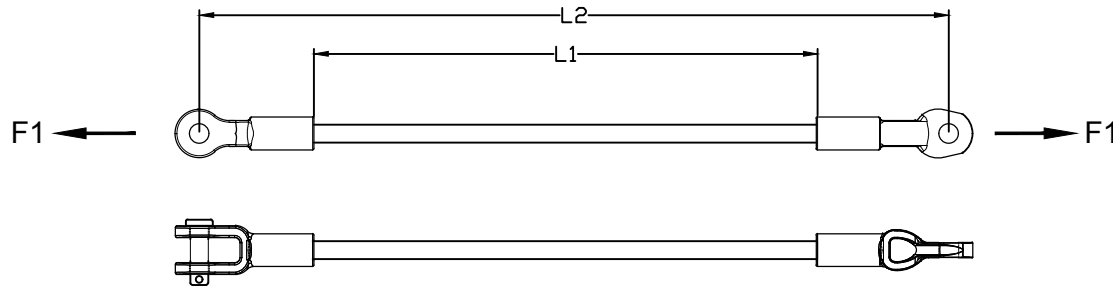

CATALOG NUMBER	LENGTHS (IN)		ULTIMATE STRENGTHS	ELECTRICAL WITHSTAND	
	L1	L2	TENSILE, LBS (F1)	DRY, kV	WET, kV
GCTE15-6.75	6.75	15.375	15,000	50.5	25.25
GCTE15-12	12	20.625	15,000	90	45
GCTE15-18	18	26.625	15,000	135	67.5
GCTE15-24	24	32.625	15,000	180	90
GCTE15-30	30	38.625	15,000	225	112.5
GCTE15-36	36	44.625	15,000	270	135
GCTE15-42	42	50.625	15,000	315	157.5
GCTE15-54	54	62.625	15,000	405	202.5
GCTE15-60	60	68.625	15,000	450	225
GCTE15-78	78	86.625	15,000	585	292.5
GCTE15-96	96	104.625	15,000	720	360
GCTE15-108	108	116.625	15,000	810	405
GCTE15-120	120	128.625	15,000	900	450
GCTE15-144	144	152.625	15,000	1080	540

- NOTES:**
- 1.0 MATERIAL
    - 1.1 END FITTING - DUCTILE IRON 654512
    - 1.2 ROD - FIBERGLASS
    - 1.3 CLEVIS PIN - C1018 STEEL (SAE GRADE 2)
    - 1.4 COTTER KEY - STAINLESS STEEL
  - 2.0 FINISH
    - 2.1 END FITTING - HOT DIP GALVANIZED PER ASTM-A-153
    - 2.2 ROD - ULTRAVIOLET PROTECTIVE VEIL COATING, GRAY  
- SILICONE COATED RUBBER FIBERGLASS ROD, GRAY FOR "SC" OPTION
    - 2.3 CLEVIS PIN - HOT DIP GALVANIZED PER ASTM-A-153
    - 2.4 COTTER KEY - NONE
  - 3.0 DIMENSIONS IN INCHES

NOTE: ADDED SUFFIX "R" FOR ROLLER. EX. GCTE15-78R.  
 ADDED SUFFIX "SC" INDICATES SILICONE COATED RUBBER FIBERGLASS ROD. EX. GCTE15-78R-SC  
 ADDED SUFFIX "WC" INDICATES IT IS PACKED IN A WOOD CRATE.  
 ADDED SUFFIX "GK" INDICATES IT IS USED IN A GUY KIT AND IS NOT BOXED.

**MACLEAN POWER SYSTEMS**  
 A Maclean-togg Company

GCTE15-"L1" & GCTE15-"L1"-R SERIES  
 15K GUY STRAIN INSULATOR  
 CLEVIS END FITTING, THIMBLE-EYE END FITTING

DATE: 9-23-11 SCALE: 1:1  
 DES: KK CHK: [ ] APP: [ ]  
 DR: [ ] DT: [ ]

NO. CEB-3814

R 0 SH [ ]  
 OF [ ]

This information is confidential and is the property of Maclean Power Systems. It may not be made public or reproduced except that the Customer may make copies for use solely in installation, maintenance, and operation of products supplied by Maclean Power Systems.

ENG. REF.