

A FULL LINE OF DEFENSE

Our family of distribution line post insulators were built with flexibility and efficiency in mind, simplifying installation while ensuring premium protection.

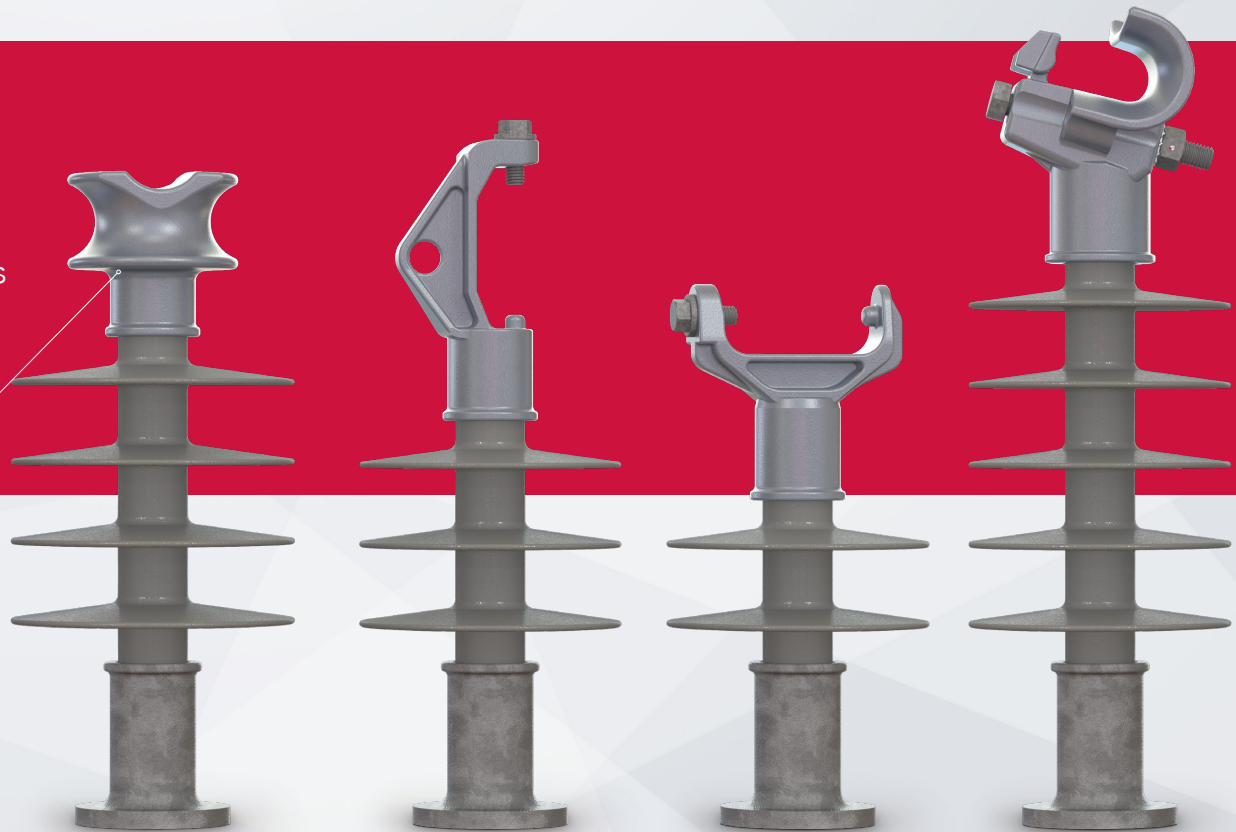

● **F-NECK**
H04070008MXSS004

● **HORIZONTAL TRUNNION**
H04020006MXSS003

● **VERTICAL TRUNNION**
H04060004MXSS002

●● **UNIVERSAL TRUNNION**
H040U0010MXSS005



- **EXTENDED LIFE**
Specially formulated silicon housing material maximizes hydrophobicity and minimizes maintenance needs.

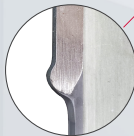

- **WATER TIGHT**
Our PST seal uses Crimp Under Pressure technology to create a water tight seal and significantly extends service life.



- **ALUMINUM CONSTRUCTION**
Aluminum conductor-side end fittings create a lighter, corrosion-resistant solution for added safety, simplicity and durability.



- **MECHANICAL STRENGTH**
All products meet or exceed performance criteria standards ANSI C29.18 and CSA C411.6.



Assembled & Delivered with personalized care from our USA & Canada based MacLean Power Systems Team.



- **SIMPLE**
All-inclusive design eliminates the need to purchase a trunnion clamp separately, as all clamp parts are captive.

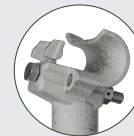

- **ADJUSTABLE**
Conductor ranges spanning 0.2" to 1.3" (5.1mm to 34.0mm) with a single bolt adjustment that is hotstick workable.

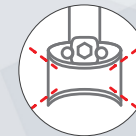

- **HORSESHOE SHAPE**
Flared horseshoe shape accommodates a wide range of motion.



- **VERSATILE**
The user-friendly 15 kV to 46 kV installation can be positioned in a variety of orientations.

THE POWER OF PST

Our proprietary PST seal system sets us apart from other designs in the market, boasting a three stage (Primary, Secondary, Tertiary) sealing process that provides three barriers for moisture protection.

Composite core composed of epoxy and corrosion resistant fiberglass. Exceptional strength with decades of performance.

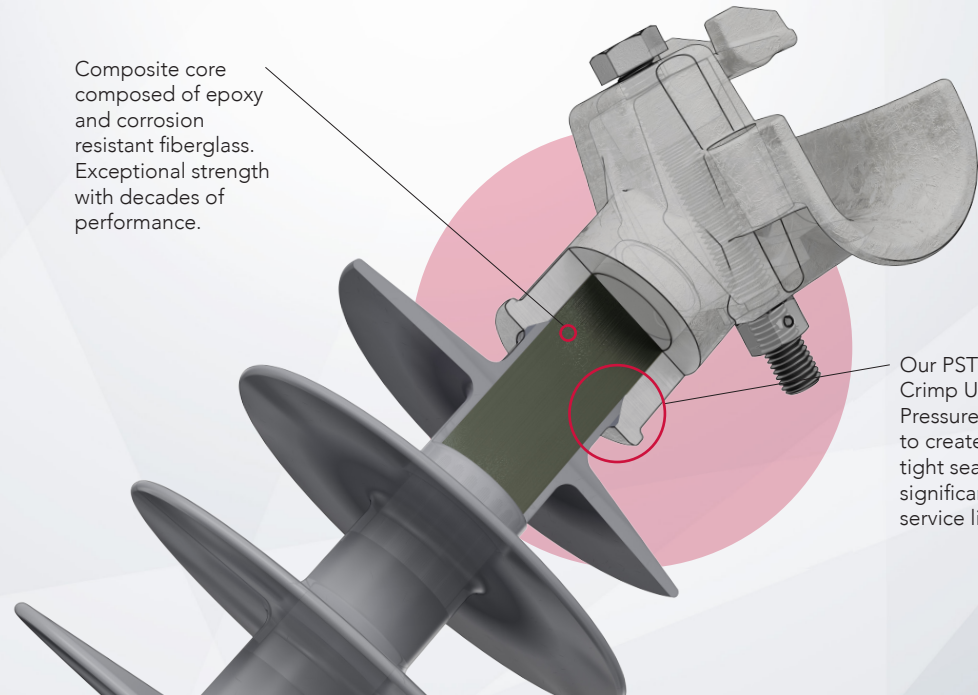

Our PST seal uses Crimp Under Pressure technology to create a water tight seal and significantly extends service life.

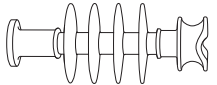
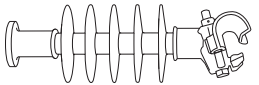
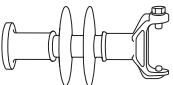
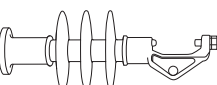
	Line Voltage (kV)	Catalog Number	ANSI Class	Assembly Weight lb/[kg]	Rubber Length in/[mm]	Section Length in/[mm]	Dry Arc in/[mm]	Leakage in/[mm]	STL lbs/[kN]	SCL lbs/[kN]	MDCL lbs/[kN]	Units per Carton	Units per Pallet
F-Neck 	15	H04070004MXSS002	51-1F	6.9 [3.1]	4.0 [101]	11.7 [297]	6.2 [158]	12.2 [310]	5000 [22.2]	2800 [12.5]	1350 [6.0]	3	90
	25	H04070006MXSS003	51-2F	7.6 [3.4]	5.9 [151]	13.7 [347]	8.2 [209]	18.3 [465]					
	35	H04070008MXSS004	51-3F	8.2 [3.7]	7.9 [201]	15.6 [397]	10.2 [259]	24.4 [620]					
	46	H04070010MXSS005	51-4F	8.9 [4.0]	9.9 [252]	17.6 [447]	12.7 [322]	31.4 [798]					
Universal Trunnion 	15	H040U0004MXSS002	ALL	7.9 [3.6]	4.0 [101]	12.6 [321]	6.2 [158]	12.2 [310]	5000 [22.2]	2800 [12.5]	1350 [6.0]	3	90
	25	H040U0006MXSS003	ALL	8.6 [3.9]	5.9 [151]	14.6 [371]	8.2 [209]	18.3 [465]					
	35	H040U0008MXSS004	ALL	9.4 [4.3]	7.9 [201]	16.6 [421]	10.2 [259]	24.4 [620]					
	46	H040U0010MXSS005	ALL	10.0 [4.5]	9.9 [252]	18.5 [471]	12.7 [323]	31.4 [798]					
Vertical Trunnion 	15	H04060004MXSS002	51-11	6.4 [2.9]	4.0 [101]	12.7 [323]	6.2 [158]	12.2 [310]	5000 [22.2]	2800 [12.5]	1350 [6.0]	3	90
	25	H04060006MXSS003	51-12	7.1 [3.2]	5.9 [151]	14.7 [373]	8.2 [209]	18.3 [465]					
	35	H04060008MXSS004	51-13	7.8 [3.5]	7.9 [201]	16.7 [423]	10.2 [259]	24.4 [620]					
	46	H04060010MXSS005	51-14	8.4 [3.8]	9.9 [252]	18.6 [473]	12.7 [322]	31.4 [798]					
Horizontal Trunnion 	15	H04020004MXSS002	51-21	6.3 [2.8]	4.0 [101]	12.0 [306]	6.2 [158]	12.2 [310]	5000 [22.2]	2800 [12.5]	1350 [6.0]	3	90
	25	H04020006MXSS003	51-22	7.0 [3.2]	5.9 [151]	14.0 [356]	8.2 [209]	18.3 [465]					
	35	H04020008MXSS004	51-23	7.6 [3.4]	7.9 [201]	16.0 [406]	10.2 [259]	24.4 [620]					
	46	H04020010MXSS005	51-24	8.3 [3.8]	9.9 [252]	18.0 [456]	12.7 [322]	31.4 [798]					

All product Meets or exceeds ANSI C29.18 and CSA C411.6 Standards
 All stud bases use 3/4"-10 hardware for attachment.
 To ensure sufficient conductor clamp pressure on the Universal Head, 60ft-lbs of torque on head bolt is recommended.