

MPS Catalog Number

NPKN 20 XG 009 S0

Date 4/29/2022

End Fittings

Tower End Fitting: Stud Base (P4 = 7/8" - 9) / 0 deg / Galv. Ductile Iron

Line End Fitting: Trunnion / Galv. Ductile Iron

Material

Mounting Angle: 0 deg

Number of Sheds: 9

Rod Diameter: 1.75 in

Weight Estimate: 10.3 lbs 4.7 kg

Dimensional Values

Section Length (X): 18.0 in 458 mm

Shed Diameter (B1): 4.1 in 105 mm

Shed Diameter (B2): 4.7 in 120 mm

Shed Spacing (C): 2.0 in 51 mm

Trunnion Bolt (F): 5/8 in - 11 bolt & lockwasher

Minimum Diameter (Z): 0.79 in 21 mm

Dry Arc Distance: 14.3 in 364 mm

Leakage Distance: 30.6 in 778 mm

Electricals Values

60 Hz dry Flashover: 151 kV Min. Withstand 142 kV

60 Hz Wet Flashover: 131 kV Min. Withstand 98 kV

Pos. Critical Impulse Flashover: 255 kV Min. Withstand 219 kV

Neg. Critical Impulse Flashover: 329 kV Min. Withstand 257 kV

Mechanical Values

Specified Tensile Load (STL): 5,000 lbs 22.2 kN

Max. Design Cant. Load (MDCL): 1,250 lbs 5.6 kN

Specified Cant. Load (SCL): 2,500 lbs 11.1 kN

This drawing contains confidential information that is the property of MacLean Power, L.L.C. ("MacLean"). Use of MacLean's confidential information without MacLean's express written consent is strictly prohibited and may expose you to legal liability. If you believe that you received this material in error, please destroy it or return it to "MacLean Power, L.L.C., 7801 Park Place Rd., York, South Carolina 29745, USA."

Notes:

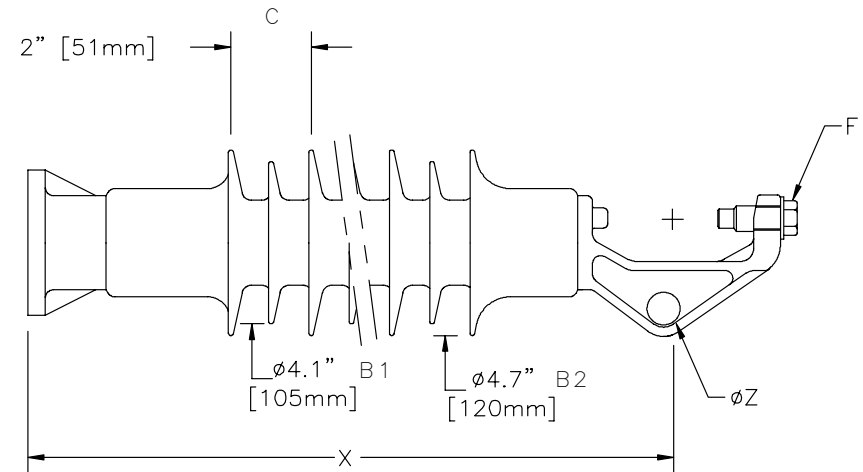
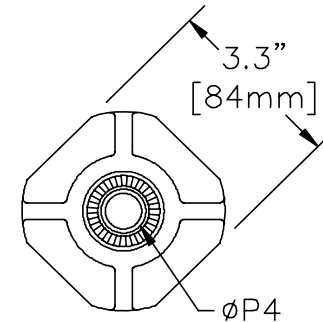

Dimension: inches [millimeters]

NOTE: Drawing not actual depiction of insulator appearance

Silicone Rubber Sheath & Sheds. Complies with applicable ANSI and IEC standards.

Prepared By: Stephen Lucci