

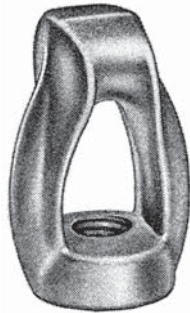

# Eyenuts



Oval Eyenuit  
Figure 1



Thimble Eyenuit  
Figure 3

## Oval, Thimble, Twineye, and Clevis Eye

Thimble eyenuts are used for span, head and stub guying, twin eyenuts accommodate double guys. Oval eyenuts are used for deadending with suspension and strain insulators or thimble clevises.

### Features

- Eyenuts are tapped to fit hot dip galvanized bolts made to ANSI specifications
- Designed to develop strength ratings consistent with the bolts with which they are used - i.e. 1/2" = 85,000 lbs, 5/8" = 133,500 lbs, 3/4" = 200,000 lbs, 1" = 335,000 lbs

### Material

Steel hot dip galvanized

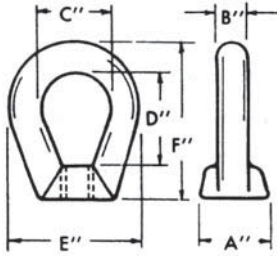

Figure 1

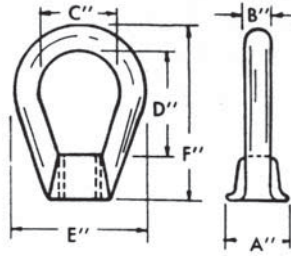

Figure 2

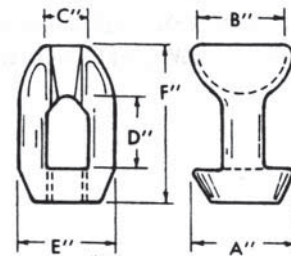

Figure 3

Catalog Number	Fig.	Bolt Size (in)	A	B	C	D	E	F	Weight /100 (lbs)
EN-4	1	1/2	1 3/8	9/16	1 1/2	1 3/4	2 5/8	3	100
J1092	1	5/8	1 3/8	9/16	1 1/2	1 3/4	2 5/8	3	72
J1093	1	3/4	1 3/8	9/16	1 1/2	1 3/4	2 5/8	3	53
ENL-5	2	5/8	1 3/8	5/8	1 1/2	2 1/2	2 5/8	4	100
ENL-6	2	3/4	1 3/8	5/8	1 1/2	2 1/2	2 5/8	4	100
J6510	3	5/8	1 1/2	1 1/2	7/8	1 3/8	1 7/8	3	100
J6511	3	3/4	1 1/2	1 1/2	7/8	1 3/8	1 7/8	3	91
J16512	3	1	2	2	7/8	1 1/2	2	4 1/2	200



## Twineye

Twin eyenuts accommodate double guys.

### Material

Steel hot dip galvanized

Twin Eyenuit			
Catalog Number	Bolt Dia. (in)	Strand Size	Weight /100 (lbs)
J6515	5/8	5/8	177
J6516	3/4	5/8	176

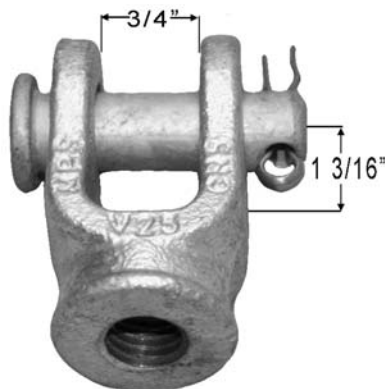

## Clevis Eyenuit

### Material

Ductile iron hot dip galvanized

Clevis Eyenuit			
Catalog Number	Bolt Dia. Tap Size	Pin Dia.	Weight /100 (lbs)
CN-5	5/8	5/8	100